

FUNDATIE TIP FT15 / FOUNDATION TYPE FT15

Vedere de sus A-A / Top view A-A
Scara 1:20 / Scale 1:20

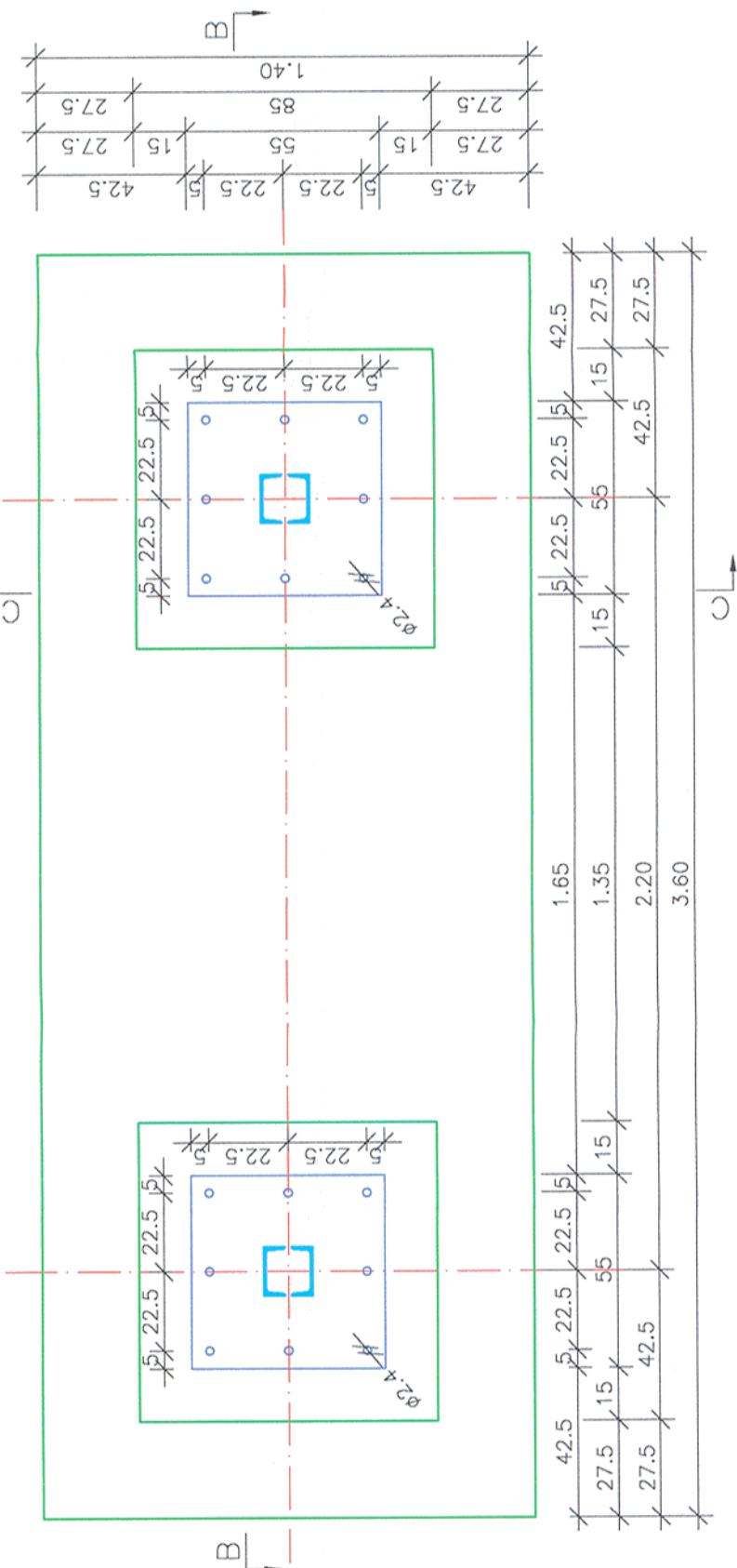

Sectiune transversala B-B / Cross section B-B
Scara 1:20 / Scale 1:20

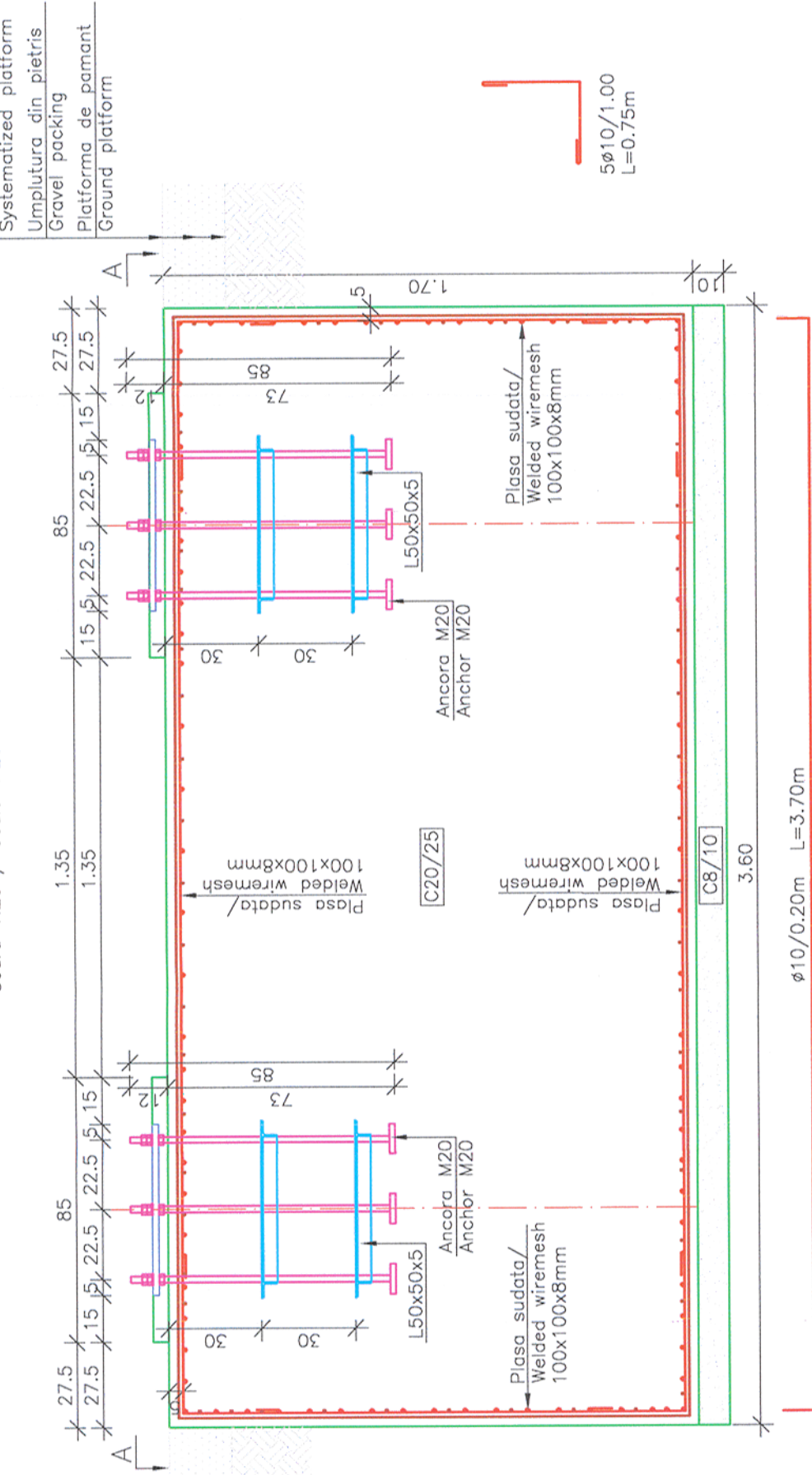

Sectiune transversala C-C / Cross section C-C
Scara 1:20 / Scale 1:20

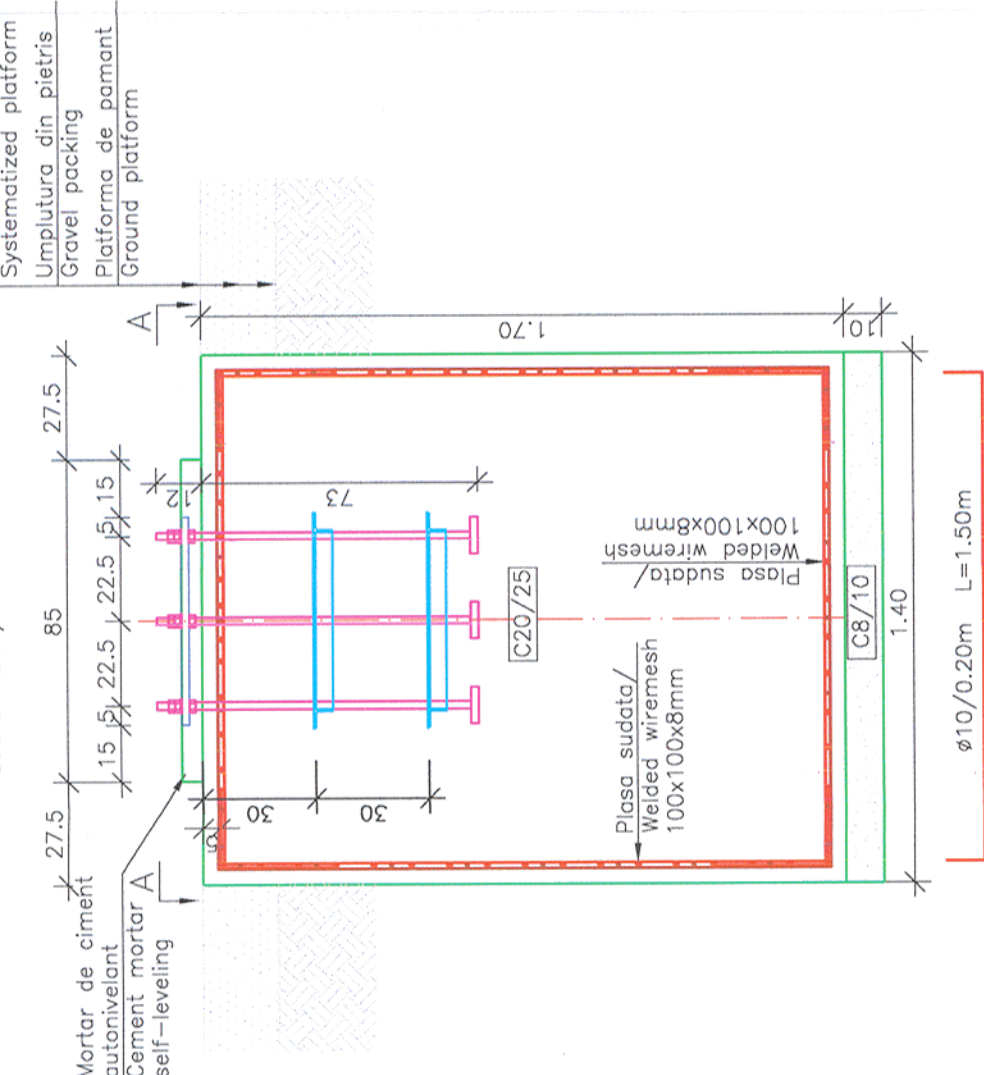

CLASA DE IMPORTANTA A CONSTRUCTIEI
CONFORM P100/1-2006 ESTE (III)
CATEGORIA DE IMPORTANTA
CONFORM HG nr. 766/97 este (C)

THE CONSTRUCTION IMPORTANCE CLASS,
ACCORDING TO P 100/1-2006, IS (III)
THE IMPORTANCE CATEGORY,
ACCORDING TO HG 766/97 IS "C"

MATERIALE:

Beton simplu C8/10;
Beton armat C20/25 CEM III/A-S 42.5 N ; sort 0-31; A/C : 0.55 ;
Otel Beton Bst 500 ;
Clasa de expunere: XC2

MATERIALS:
Concrete C8/10 ;
Reinforced concrete C20/25 CEM III/A-S 42.5 N ; sort 0-31 A/C : 0.55 ;
Reinforcement Bst 500 ;
Exposure class: XC2

NOTĂ / NOTE:

Toate tipurile de oțel (în special Bst 500) vor avea obligatoriu clasa de ductilitate C.
All types of steel (especially Bst 500) will mandatory have the ductility class C.

Proiectul de structura se va corela cu proiectul celorlalte specialități (parte scrisă și parte desenată).
The structural project (blueprints, technical briefs, technical specifications) will be correlated with the other specialities' projects (blueprints, technical briefs, technical specifications).

Acest plan anuleaza si inlocuieste planul nr. PT.02.04.12.RE.09.008 elaborat la data 01.2013.

This layout plan canceled and replaced layout plan no. PT.02.04.12.RE.09.008 prepared on 01.2013.

Verificator / Expert Checker / Expert	Cerința Requirement	Semnătura Signature	Referat / Expertiză Report / Expertise

PROIECTANT / DESIGNER:		Data Date	Semnătura Signature
Aprobat Approved	Șef de echipă Team leader	01.2013	
Verificat Checked	Expert Cheie Key Expert	01.2013	
Subcontractant / Subcontractor			
Aprobat Approved	Adjunct Șef de echipă Deputy Team leader	01.2013	
Proiectat Designed	Inginer Engineer	01.2013	
"Reabilitarea liniei c.f. Curtici - Simeria, parte componentă a coridorului IV Pan - European pentru circulația trenurilor cu viteză maximă de 160 km/h"		Project 9i 35311.1	
"Rehabilitation of the Railway Line Border - Curtici - Simeria, component Part of the IV Pan - European Corridor for the Trains Circulation with maximum speed of 160 km/h"		Faza / Phase: PTh+CS / TD+TS	
"Rehabilitation of the Railway Line Border - Curtici - Simeria, component Part of the IV Pan - European Corridor for the Trains Circulation with maximum speed of 160 km/h"		Section 2 - B: End Y Bărzava - End Y Iltcu	
Denumire desen / Drawing name: Fundatie tip FT15 - Substație de tracțiune - Stația Vărădia / Foundation type FT15 - Traction substations - Vărădia Station			
Scara / Scale 1:20	Revizia / Revision 1/05.2013	Cod desen / Drawing Code PT.2B.04.12.RE.09.008	Nr / No 08/12